

Case study: Berengrave Nursery, Rainham, Kent

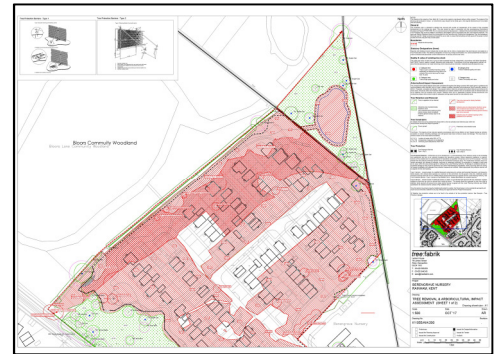

Outline consent for 121 residential dwellings plus associated infrastructure delivered within 18 months.

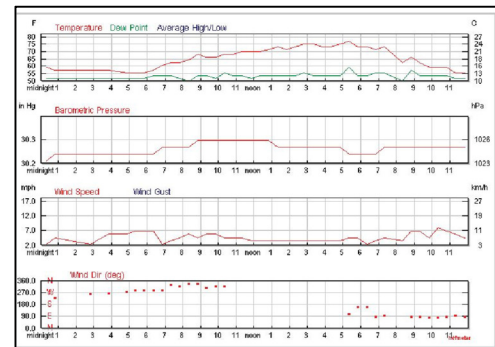

- The site is situated on the west side of Berengrave Lane where countryside meets urban edge and residential dwellings where sensitive noise assessments were required.
- The land was formerly occupied by a number of the businesses including a garden nursery, shed, stables, archery display area, office building and greenhouse.
- Resolution to grant planning permission was achieved in February 2018 and the Section 106 agreement was signed in March 2018.
- The land was initially contracted in February 2017 under a promotion agreement and outline planning consent achieved in just over 12 months. Completion of the land sale is due September 2018;
- Outline Planning Permission for up to 121 residential units plus new site access, open space, SUDS, earthworks and associated landscaping works.

Sentinel House
Harvest Crescent
Ancells Business Park
Fleet GU51 2UZ

01252 360 300
www.gleesonstrategicland.co.uk

